

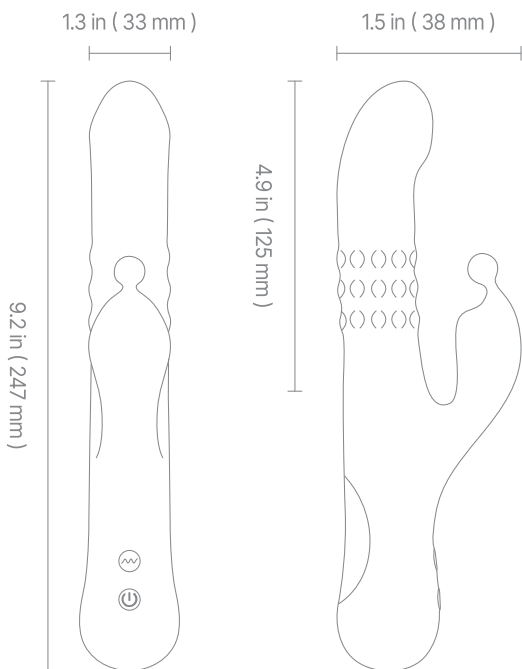

QUICK START GUIDE

SIZE



SPECIFICATIONS

Material: Silicone+ABS

Size: 34 × 80 × 247 mm

Mode: 10 Vibration + Digging + Swelling Modes

Charging Time: 90 -120 min

Using Time: ≥50 min

Waterproof: IPX6

FUNCTION

- Turn ON/OFF:
Press and hold "⏻" button for 2 seconds.
- Switch A head frequency settings:
Quickly press "⏻" button to switch A head vibration, digging and swelling frequency cycle;
Double-click the "⏻" to pause A head vibration, digging and swelling frequency cycle;
- Switch B head frequency settings:
Quickly press "⚡" button to switch B head vibration frequency cycle;
- Double-click the "⚡" to pause B head vibration function.
- FLASHING light = Charged;
SOLID light = Fully Charged.
- Low Battery reminder
the light flashes quickly until it's turned off.

USB CHARGING

*WARNING: Please DO NOT use adaptor with ">5V" output

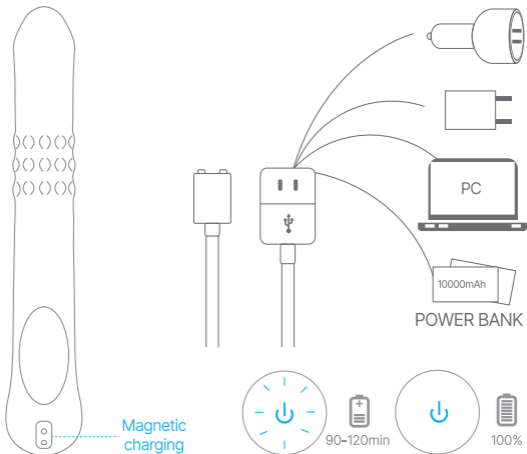

- Connect the device to USB port to charge.
- Do not use the device while charging.
- Please connect with power adaptor below 5V.
- Do not submerge under water.
- If the product is not charging while plugged in, please wait 10 minutes and try again.

PRODUCT CLEANING

- Please clean it thoroughly before and after using.
- Warm water and medicinal alcohol can be used to clean this product, but warm water is highly recommended.
- Naturally air dry and avoid direct sunlight.
- Store it in a dust-free place.

SAFETY

- Don't share it with others for your health.
- Stop using it if you feel uncomfortable.
- Keep it from children's reach.

ATTENTION

- Please charge it before using.
- Please use good quality personal lubricant. Something (Massageoil, hand cream or cleaning solution etc.) containing hazardous substances cannot be used as lubricant.



MADE IN CHINA